

8 7 6 5 4 3 2 1

THE INFORMATION CONTAINED IN THIS DRAWING IS THE SOLE PROPERTY OF SALCOR. ANY REPRODUCTION IN PART OR WHOLE WITHOUT THE WRITTEN PERMISSION OF SALCOR IS PROHIBITED.

REVISIONS			
REV.	DESCRIPTION	DATE	APPROVED

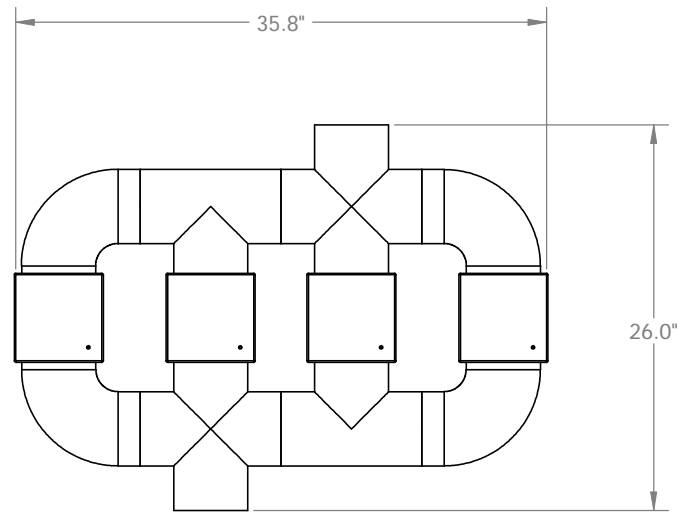
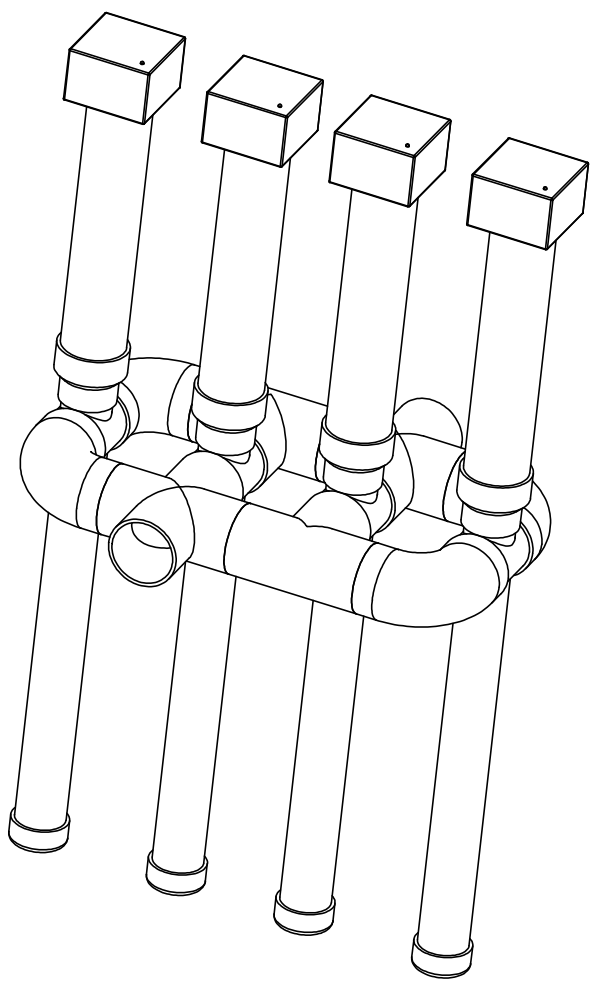

- NOTES (UNLESS OTHERWISE SPECIFIED):
1. PEAK FLOW: 36,000 GALLONS PER DAY
 2. INLET AND OUTLET PORTS 4" SCHEDULE 40 PIPE

UNLESS OTHERWISE SPECIFIED
DIMENSIONS ARE IN INCHES
TOLERANCES ARE:
FRACTIONS .XX±01 ANGLES ±1°
± 1/64 .XXX±.005

CAD GENERATED DRAWING.
DO NOT MANUALLY UPDATE

APPROVALS	DATE
DRAWN EW	3/7/11
CHECKED	
RESP ENG	
MFG ENG	
QUAL ENG	

SALCOR

4-UP PARALLEL

SIZE	DWG. NO.	REV.
B	4-up - parallel	1
SCALE 1:8	CAD FILE:	SHEET 1 OF 1

8 7 6 5 4 3 2 1